

SCHNEEBERGER
LINEAR TECHNOLOGY

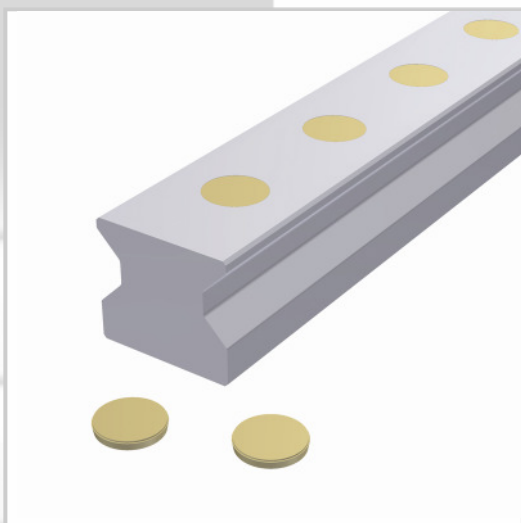

Installation Instructions

**Brass Plugs MRS
for MONORAIL MR**



Version data

Date written	Description	Author	Released by
07.12.2007	First release	JS	KG

Version	Date	Description	Released by

Notes for users

These instructions have been prepared with great care and all information checked for correctness. Notwithstanding this, no liability can be accepted for faulty or incomplete information. Due to the further development of our products, we reserve the right to make changes to information and technical data. Reproduction or copying, even of excerpts, is forbidden without our prior written permission.

The Installation Instructions MRS for MONORAIL MR can be obtained free of charge from your Schneeberger Partner, or downloaded as a pdf-file from **www.schneeberger.com**.

Document No.: **826 003 061**

Printed in Germany

Contents

1	About these Installation Instructions	4
1.1	Function and validity	4
1.2	Target audience	4
1.3	Further reading	4
2	For your safety	4
2.1	Authorised persons	4
2.2	General safety and accident prevention measures	4
3	Operating principle	5
4	Preparing for installation	5
4.1	Tools, materials and equipment required	5
4.2	Hydraulic unit	5
4.3	Installation tool MWH	6
4.4	Preparing the rail	6
5	Installation	7
5.1	Preliminary fitting of plugs	7
5.2	Final installation of plugs	9
5.3	Completion of installation	9
6	Removing brass plugs	10
6.1	Tools required	10
6.2	Operating principle	10
6.3	Procedure	10
6.4	Recommended screw sizes	11
7	Maintenance	11
7.1	Installation tool MWH	11
7.2	Hydraulic cylinder MZH	11
8	Appendix	12
8.1	Dimensions of brass plugs	12
8.2	Dimensions of installation tool	12
9	SCHNEEBERGER - Group	14

1 About these Installation Instructions

1.1 Function and validity

The Installation Instructions for Brass Plugs MRS for MONORAIL MR describes the installation of MRS brass plugs to cover the rail mounting holes on MONORAIL MR guideways using the MWH hydraulic installation tool. These instructions supplement the MONORAIL Installation Instructions and are only valid in conjunction with them.

1.2 Target audience

These Installation Instructions are intended for the fitters and service personnel who have to install brass plugs or replace them during servicing operations.

1.3 Further reading

- MONORAIL catalogue
- MONORAIL Installation Instructions
- Hydraulic cylinder operating instructions (included in scope of supply)

Catalogues and installation instructions can be obtained from SCHNEEBERGER representatives or downloaded from **www.schneeberger.com**.

2 For your safety

2.1 Authorised persons

MRS brass plugs may only be installed by specialist personnel who have read and understood these Installation Instructions and the operating instructions for the hydraulic components.

2.2 General safety and accident prevention measures



Caution:

Danger of injury from sharp-edged bores in guide rails and from sheared off or ejected brass chips when installing plugs.

- ➔ Wear gloves
- ➔ Wear protective goggles when working with compressed air

Hydraulic components

Observe the relevant manufacturer's installation, operation and maintenance instructions without fail at all times to prevent injury and damage to property when operating hydraulic components.

3 Operating principle

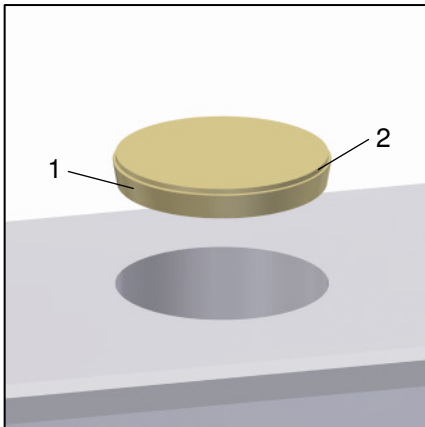

MRS brass plugs are tapered externally (1). The outside diameter is slightly larger than the bore diameter in the rail. During installation, material is displaced and sheared off; this is assisted by a stepped ring adjacent to the upper surface of the plug (2). This creates a gap-free, liquid-tight interference fit between the plug and the bore in the rail. This ensures, besides a secure fit for the plug, an optimum running surface for the carriage wipers.

4 Preparing for installation

4.1 Tools, materials and equipment required

- Commercially-available hydraulic unit
- Hydraulic installation tool, type MWH, including hydraulic cylinder MZH
- Hexagon key, 8 A/F, for assembling installation tool MWH
- Mounting rail MRM
- Compressed air gun
- Scalpel or pointed knife
- Brass brush
- Polishing pad
- Lubricant
- Soft rag

4.2 Hydraulic unit



A normal, commercially-available hydraulic unit is required to supply pressure for the installation tool. As a rule, this consists of an electric motor driving a pump (1), an oil reservoir (2), a pressure regulator with a pressure gauge (3) and an operating panel (4).

Recommended performance data:

- Nominal working pressure 200 to max. 350 bar
- Flow rate > 0,5 l/min.

4.3 Installation tool MWH

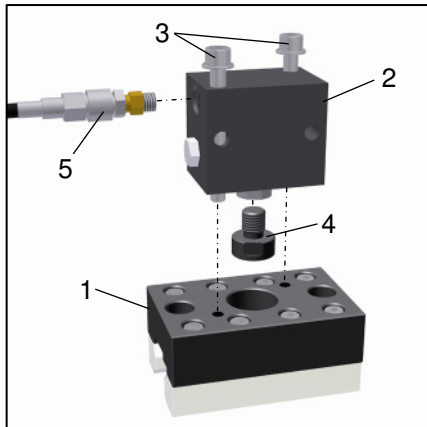

For correct installation of brass plugs, SCHNEEBERGER recommends the hydraulic installation tool MWH. This consists of a size-dependent MWH sliding shoe with punch and the universal hydraulic cylinder MZH; it must be ordered separately. The cylinder is a single-acting block cylinder with spring return. .

Order code for sliding shoe: **MWH xx**
xx = size; ordering example: 1 x MWH 45

Order code for hydraulic cylinder: **MZH**
Ordering example: 1 x MZH

Assembly

Screw the punch (4) by hand into the hydraulic cylinder (2) up to the shoulder and tighten it gently. Then fasten the hydraulic cylinder to the sliding shoe (1) using the screws (3) supplied. Use a commercial quick connector (5) (not included in scope of supply) to connect the hydraulic unit to the 1/4" hydraulic thread on the cylinder.

Dimensions of the installation tool see chapter 8.2.

4.4 Preparing the rail

- Install the rail according to the MONORAIL Installation Instructions and tighten the screws securely.
- Remove the carriage from the rail using mounting rail MRM if necessary.



Notice:

Before moving the carriage, ensure that the corrosion protection coating applied in our works has been removed completely; see MONORAIL Installation Instructions. The corrosion protection can stick the rolling elements together, thus cause a damage on the carriage.

- Clean the upper surface of the rail and the mounting holes. There must be no large particles of dirt or swarf in the rail mounting holes.
- Make sure that the edges of the rail mounting holes have sharp edges and are not damaged.
- Apply a light coating of oil to the upper surface of the rails and mounting holes if necessary.

5 Installation

5.1 Preliminary fitting of plugs

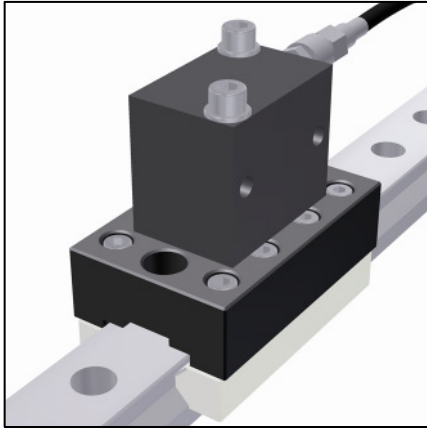

Slide the installation tool on to the rail. To do this, we recommend using a mounting rail MRM.

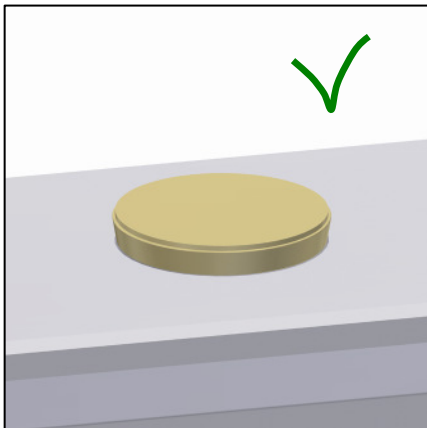

Place the plugs in the rail holes with the smaller end of their taper downwards.

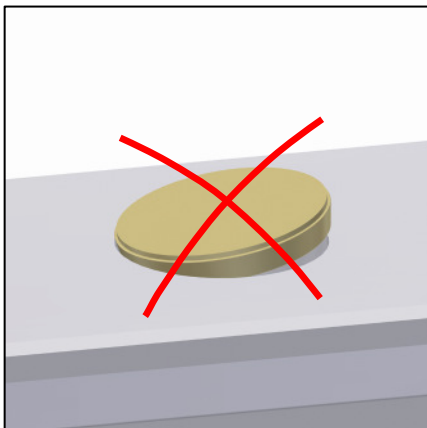

Ensure that the face of the plug is plane parallel to the upper surface of the rail.

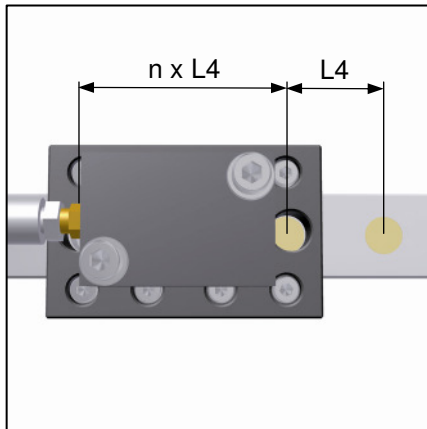

Slide the installation tool over the plug and position it centrally. The pressing position is reached when the two external inspection holes, or the cut-outs in the tool are over a rail mounting hole. Depending on the size, the inspection holes may be one or two pitches ($L4$) from the installation position.

Please note:

For installing the plug at the extreme end of the rail, the installation tool can be positioned so that it partly overhangs the rail end.

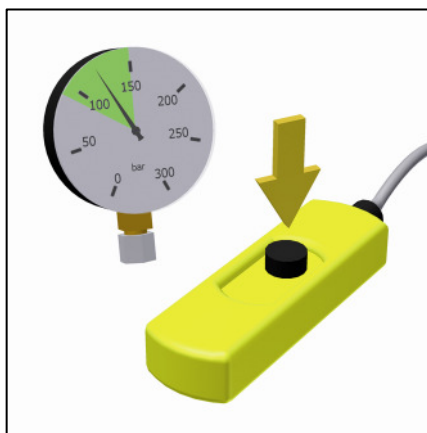

Switch on the hydraulic unit and set the desired pressure on the pressure regulator.

The required pressure can change depending on the size and due to manufacturing tolerances. Depending on the size, we recommend a pressure between 80 and 120 bar. Occasionally, a higher pressure may be necessary.

Start with a low pressure and increase in steps according to the installation results.



Caution:

The permissible operating pressure of the hydraulic cylinder is 350 bar. This pressure must never be exceeded.

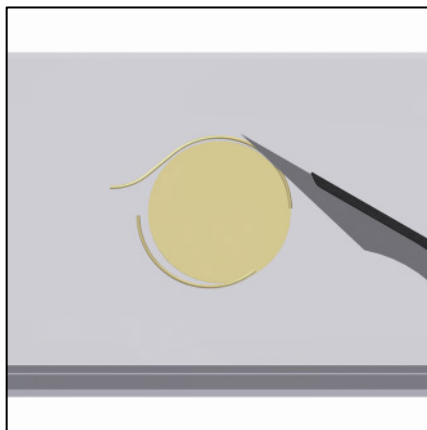

Operate the hydraulic cylinder for just a short period from the control panel until a click can be clearly heard. Then release the operating button immediately so that the cylinder returns to its original position. Push the installation tool to one side. The plug is now pre-installed and projects 0.2-0.3 mm above the upper surface of the rail.

During the pressing operation, plug material is sheared off in the form of a circular "chip", which will now lie around the plug on the rail top surface. Use a scalpel or pointed knife to separate the chip if it is still connected to the plug. Take care that neither the plug nor the rail are scratched during this operation.

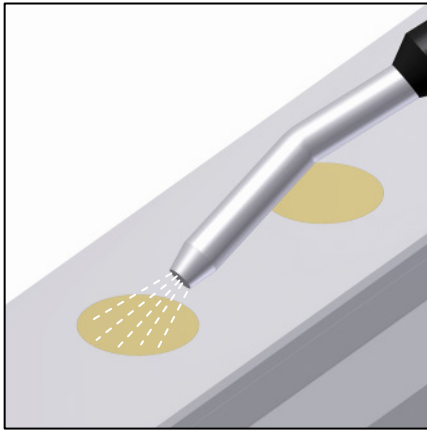

Use compressed air to blow the loose chip from the upper surface of the rail. If necessary remove any residual swarf with a brass brush. Check that all swarf has been removed completely.

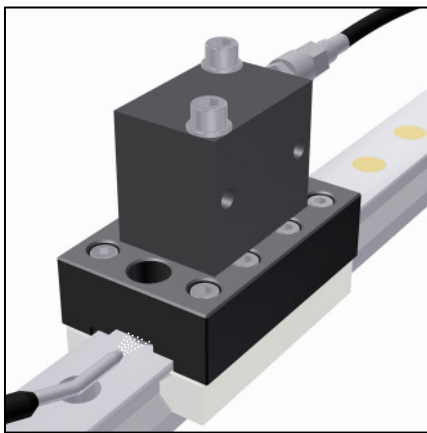

Blow compressed air through the gap between the sliding shoe and the upper surface of the rail to clear any swarf adhering to the punch.

5.2 Final installation of plugs

Slide the installation tool over the plug again and position it. Repeat the pressing operation as described in Section 5.1 and press the plug in until it is flush.

5.3 Completion of installation

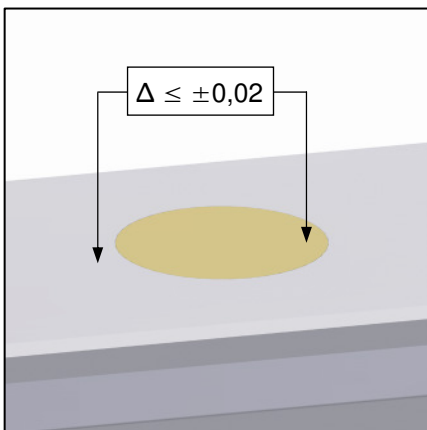

After pressing in all the plugs, check that they are correctly seated. The maximum permissible difference in height between the rail and surface of a plug is ± 0.02 mm measured at the edge of the plug. If necessary, repeat the pressing operation at a higher pressure until the correct position is reached.

Ensure that there are no residual chips or burrs. If necessary, clean up the plugs and the upper surface of the rail with a polishing pad.

6 Removing brass plugs

6.1 Tools required

- Electric drill
- Thread-cutting tap
- Drill
- Centre punch
- Hexagon socket screw e.g. to DIN 912 / ISO 4762
- Hexagon key

6.2 Operating principle

If they have been correctly installed, brass plugs are very securely retained in the rail holes. We therefore recommend removing them with the aid of an extraction screw. A standard hexagon socket screw can be used for this purpose. The recommended screw sizes and tapping hole diameters are given in a table in chapter 6.4.

6.3 Procedure

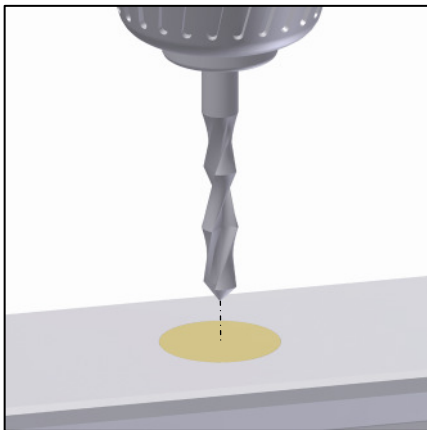

Make a centre-punch dot in the middle of the plug to be removed and drill carefully through the centre of the plug using an electric drill. Take care not to damage the rail mounting screw. The drill diameter should be the core diameter of the thread to be cut in the plug.

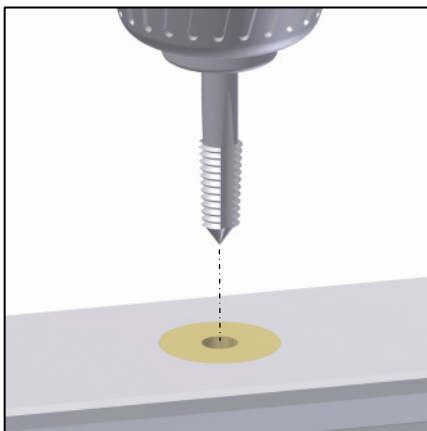

Use a suitable tap to cut a metric thread in the plug. Then clean any remaining swarf from the thread and hole.

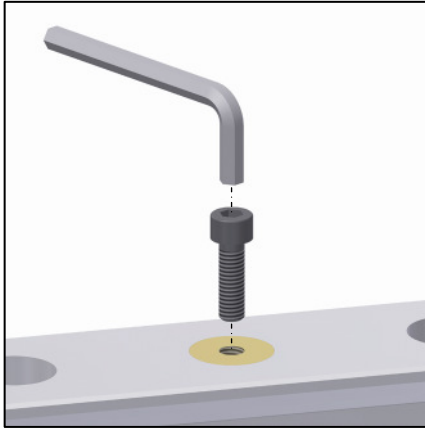

Screw a hexagon socket screw into the plug by hand until the end of the screw contacts the rail mounting screw.

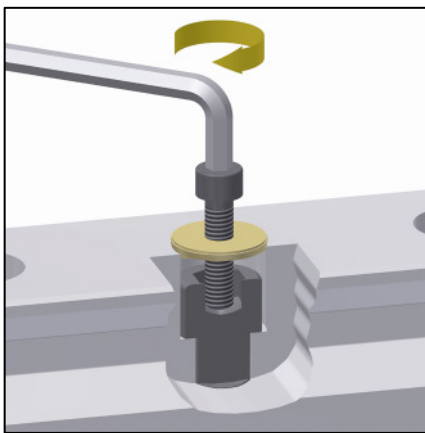

Turn the screw further with a suitable hexagon key. This action will draw the plug upwards out of the bore, see figure on the left. Continue to turn the screw until the plug has been extracted and can be removed by hand.

Finally, make sure that neither the hole in the rail nor the mounting screw has been damaged. If necessary, clean up the bore with a grinding tool and replace the mounting screw.

6.4 Recommended screw sizes

Brass plug	Screw	Ø Core hole
MRS 25 – MRS 35	M4	3,3
MRS 45 – MRS 65	M6	5

All dimensions in mm

7 Maintenance

7.1 Installation tool MWH

The installation tool MWH is, in principle, maintenance free, but, after a long period of use, the punch may exhibit signs of wear. This may result in the position tolerance for the plugs being exceeded. The punch should be inspected at regular intervals and replaced if necessary.

The punch can be purchased from SCHNEEBERGER as a spare part.

Order code for punch: **SP xx-MWH**

xx = size; ordering example: 1 x SP 45-MWH

7.2 Hydraulic cylinder MZH

Follow the maintenance instructions in the manufacturer's operating instructions.

8 Appendix

8.1 Dimensions of brass plugs

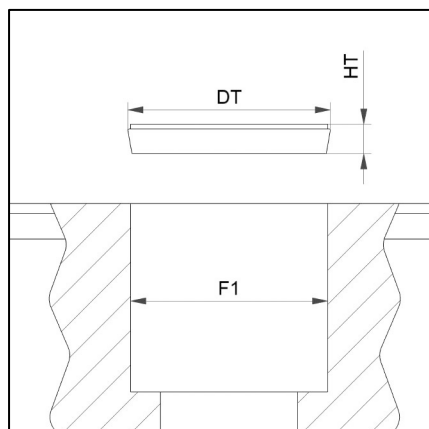

Size	Ø DT	HT	F1
MRS 25	11,5	2,5	11
MRS 35	15,5	3	15
MRS 45	20,5	3	20
MRS 55	24,5	3	24
MRS 65	26,5	3	26

All dimensions in mm

8.2 Dimensions of installation tool

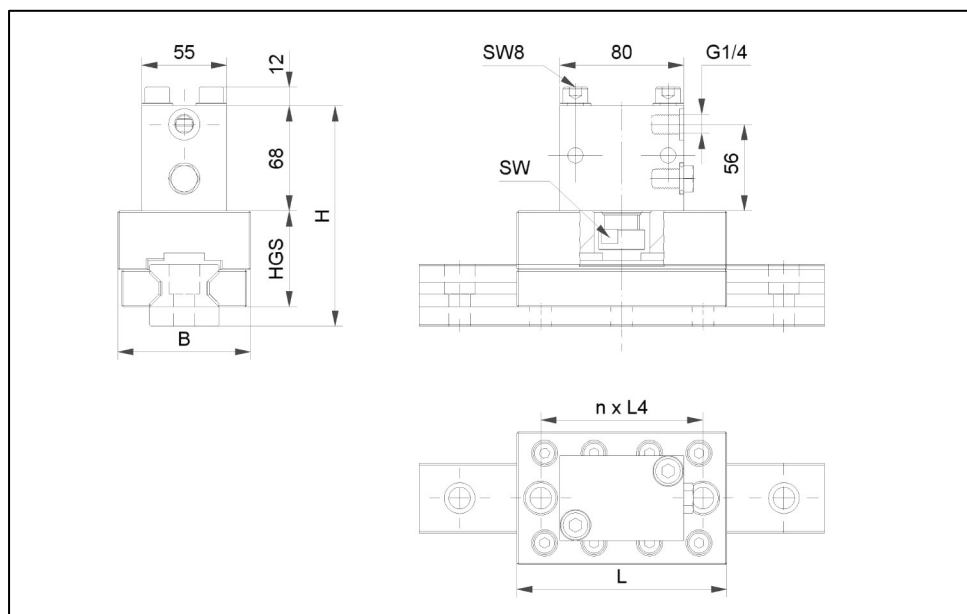

Size	L	B	H	HGS	SW	n x L4
MR 25	120	55	128	52	20	120
MR 35	150	70	135,5	58	20	160
MR 45	136	86	142,5	62	27	105
MR 55	156	98	150	67	30	120
MR 65	150	118	158	72	32	150

All dimensions in mm

SCHNEEBERGER AGENCIES

EUROPE

AUSTRIA

Haberkorn GmbH
6961 Wolfurt
Phone: +43 5574 695-0
Fax: +43 5574 695-99
info.wolfurt@haberkorn.com

BULGARIA / MACEDONIA

Atlas Technik EOOD
Hippodroma, Bl. 139B, Eing. A, App. 6
1612 Sofia, PB 51
Bulgarien
Phone +359 2 859 76 81
Fax +359 2 859 76 81
Mobil +359 8 852 32 595
E-Mail: al_popoff@techno-link.com

CROATIA

Haberkorn CRO d.o.o.
10431 Sveta Nedelja
Phone +385 1 333 5870
Fax +385 1 337 3902
E-Mail: info@haberkorn.hr

DENMARK

HERSTAD + PIPER A/S
Jernholmen 48c
2650 Hvidovre
Phone +45 367 740 00
Fax +45 367 777 40
E-Mail: mail@herstad-piper.dk

FINLAND

EIE Maskin OY
PL, 80 Asematie 1
10601 Tammissaari
Phone +358 192 239 100
Fax +358 192 239 199
E-Mail: info@eie.fi

FRANCE

Region Rhône-Alpes
Groupe BARET
6 avenue du 11 novembre 1918
69200 Venissieux
Phone +33 4 78 77 32 32
Fax +33 4 78 00 90 00
E-Mail: contact@bare.fr

Regions Ile de France, Normandie, Bretagne

Groupe LECHEVALIER
56 rue Jean Mermoz
Parc d'activités de la Bretèque
76230 Bois-Guillaume Cedex
Phone +33 2 35 12 65 65
Fax +33 2 35 59 89 97
E-Mail: contact@lechevalier-sa.com

Region Nord Pas de Calais

LEFRANC LTL «Le Panetier»
35, rue Pierre Martin
Parc d'Activités de l'Inquétie
62280 Saint Martin Boulogne
Phone +33 3 21 99 51 51
Fax +33 3 21 99 51 50
E-Mail: lefranc.boulogne@lefranc-sa.fr

GERMANY

BGP-Blazevic Geradlinige Präzisionstechnik
Stipo Blazevic
Hochstiftstrasse 31
93055 Regensburg
Phone +49 941 569 996 20
Fax +49 941 569 950 97
Mobil +49 151 401 126 25
E-Mail: info@bgp-blazevic.de

GREAT BRITAIN

LG Motion Ltd.
Unit 1 Telford Road
Houndmills Estate, Basingstoke
Hampshire RG21 6YU
Phone +44 012 563 656 00
Fax +44 012 563 656 45
E-Mail: info@lg-motion.co.uk

EUROPE

HUNGARY

Haberkorn Kft.
Asztalos Sándor u.12
Budapest, 1087
Phone +36 13030325
Fax +36 1/3030262
E-Mail: office@haberkorn.rs

ITALY

Nadella S.r.l.
Via Melette, 16
20128 Milano
Phone +39 022 709 329 7
Fax +39 022 551 768
E-Mail: customer.service@nadella.it

NORWAY

Elmeko AS (s. EIE Maskin)
Tvetenveien 164
0671 Oslo
Phone +47 675 722 70
Fax +47 675 722 80
E-Mail: elmeko@elmeko.no

POLAND

TECHNIKA LINIOWA
Rolico Rolling Components
Ul. Cegielniana 21
42-700 Lubliniec
Phone +48 343 510 430
Fax +48 343 510 431
E-Mail: rollico@rollico.com

ROMANIA

Meximpex SRL
4, Burebista Blvd.,
bl. D13 sc. A et 2 ap. 9-10
031108 Bucharest
Phone +40 213 166 843 /44
Fax +40 213 166 846
E-Mail: office@meximpex.ro

SERBIA/MONTENEGRO

Haberkorn d.o.o.
Kralja Petra I, 59
21203 Veternik,
Phone +381 21 3 101 555
Fax +381 21 3 101 554
E-Mail: office@haberkorn.rs

SLOVAKIA

KBM, s.r.o.
Juraj Hajovsky
Zitná 13
010 04 Zilina
Phone +421 417 070 324
Fax +421 417 070 333
Mobile +421 090 585 1465
E-Mail: jhajovsky@kbm.sk

SLOVENIA / BOSNIA HERZEGOVINA

Haberkorn d.o.o.
Vodovodna ul. 7
2000 Maribor
Phone +386 2 320 67 10
Fax +386 2 320 67 30
E-Mail: info@haberkorn.si

SWEDEN

EIE Maskin AB
Box 7
12421 Bandhagen
Phone +46 87 278 800
Fax +46 87 278 899
E-Mail: eie@eie.se

TURKEY

Birlik Rulman (Paz.ltd.sti.)
Mumhane Cad. No: 16
80030 Karakoy-Istanbul
Phone +90 212 249 54 95
Fax +90 212 244 21 40
E-Mail: birlik@birlikrulman.com

ASIA

KOREA

Intech Automation Inc.
1-1108, Ace Hitech City
55-20 Mulla-Dong 3-Ga
Youngdeungpo-Ku
150-972 Seoul
Phone +82 2 3439 0070 - 4
Fax +82 2 3439 0080
E-Mail: intech@intechautomation.co.kr

Lineartech Inc.
369 Geumgok-ri, Dongtan-myeon
Hwaseong-si, Gyeonggi-do
445-811 Korea
Phone +82 31 274 0485
Fax +82 31 274 0486
E-Mail: lineartech@chol.com

TAIWAN / REPUBLIC OF CHINA

Ever Bright Precisiton Ltd.
1 F,nr.52
Lane 10 Chi-hu Road
114 Taipei
Phone +886 226 595 586
Fax +886 226 595 587
E-Mail: sales@everbright.com.tw

AUSTRALIA / NEW ZEALAND

RJM Engineering Supplies
Tamar Street 13
VIC 3134 Ringwood
Phone +61 398 794 881
Fax +61 398 793 700
E-Mail: rjmeng@rjmeng.com.au

SOUTH AFRICA

Fischli & Fuhrmann Ltd.
P.O Box 253
1600 Isando Gauteng
Phone +27 119 745 571
Fax +27 119 745 574
E-Mail: info@fifu.co.za

SOUTH AMERICA

Ibatech Tecnologia Ltda.
Av. Amazonas, 976
90240 542 Porto Alegre RS
Brazil
Phone +55 513 337 14 81
Fax +55 513 337 52 65
E-Mail: ibacorp@iba-corp.com

PROSPECTUSES

- COMPANY BROCHURE
- CUSTOMIZED BEARINGS
- GEAR RACKS
- LINEAR BEARINGS and RECIRCULATING UNITS
- MINERAL CASTING SCHNEEBERGER
- MINI-X MINIRAIL / MINISCALE PLUS / MINISLIDE
- MONORAIL and AMS profiled linear guideways with integrated measuring system
- MONORAIL and AMS application catalog
- POSITIONING SYSTEMS
- SLIDES



SCHNEEBERGER COMPANIES

SWITZERLAND

SCHNEEBERGER AG
St. Urbanstrasse 12
4914 Roggwil/BE

Phone +41 62 918 41 11
Fax +41 62 918 41 00

E-Mail:
info-ch@schneeberger.com

JAPAN

Nippon SCHNEEBERGER K.K.
Crane Toranomon Bldg 7F
3-20-5 Toranomon, Minato-ku
Tokyo 105-0001

Phone +81 3 6435 7474
Fax +81 3 6435 7475

E-Mail:
info-j@schneeberger.com

JAPAN

日本シュネーベルガー株式会社
〒105-0001
東京都港区虎ノ門3-20-5
クレイン虎ノ門ビル7F

電話 03 6435 7474
ファクス 03 6435 7475

Eメール:
info-j@schneeberger.com

GERMANY

SCHNEEBERGER GmbH
Gräfenau
75339 Höfen/Enz

Phone +49 7081 782 0
Fax +49 7081 782 124

E-Mail:
info-d@schneeberger.com

CHINA

SCHNEEBERGER (Shanghai) Co., Ltd.
Rm 606, Shang Gao International
Building
No. 137 XianXia Road
200051 Shanghai

Phone +86 21 6209 0037 / 27
Fax +86 21 6209 0102

E-Mail:
info-cn@schneeberger.com

CHINA

施耐博格 (上海) 传动技术有限公司
上海市长宁区
仙霞路137号盛高国际大厦606室, 上海 200051

电话 +86 21 6209 0027
传真 +86 21 6209 0102

邮箱:
info-cn@schneeberger.com

ITALY

SCHNEEBERGER S.r.l.
Via Soldani 10
21021 Angera (VA)

Phone +39 0331 93 2010
Fax +39 0331 93 1655

E-Mail:
info-i@schneeberger.com

KOREA

SCHNEEBERGER Korea Ltd.
UNION Center Building
1004, 10th FL
310, Gangnam-Daero,
Gangnam-Gu, Seoul,
Korea 135-754

Phone +82 2 554 2971
Fax +82 2 554 3971

E-Mail:
info-kr@schneeberger.com

KOREA

서울시 강남구 강남대로 310
유니온센터 빌딩 1004호
우편번호 135-754

전화 +82 2 554 2971
팩스 +82 2 554 3971

이메일:
info-kr@schneeberger.com

USA

SCHNEEBERGER Inc.
44 Sixth Road,
Woburn, MA 01801-1759

Phone +1 781 271 0140
Fax +1 781 275 4749

E-Mail:
info-usa@schneeberger.com

SINGAPORE

SCHNEEBERGER LINEAR
TECHNOLOGY PTE. Ltd.
160 Paya Lebar Road, #05-04
Orion Industrial Building
409022 Singapore

Phone + 65 6841 2385
Fax + 65 6841 3408

E-Mail:
info-sg@schneeberger.com

INDIA

SCHNEEBERGER India Pvt. Ltd.
406, 4th Floor, Satra Plaza,
Palm Beach Road, Sector 19D Vashi,
400 703 New Mumbai

Phone +91 22 6461 0646
+91 22 6461 1756

E-Mail:
info-in@schneeberger.com

SCHNEEBERGER MINERAL CASTING

CZECH REPUBLIC

SCHNEEBERGER
Mineralgusstechnik s.r.o.
Prumyslový park 32/20
350 02 Cheb – Dolní Dvory

Phone +420 354 400 941
Fax +420 354 400 940

E-Mail:
info-mineralguss@schneeberger.com

CHINA

SCHNEEBERGER Changzhou
Precision Systems Co. Ltd.
137 Hanjiang Road
Changzhou New district
213000 Changzhou, Jiangsu

Phone +86 519 8988 3938
Fax +86 519 8988 5115

E-Mail:
info-mineralcasting@schneeberger.com

CHINA

施耐博格 (常州) 测试系统有限公司
汉江路137, 常州新区, 常州213022

电话 +86 519 8988 3938
传真 +86 519 8988 5115

邮箱:
info-mineralcasting@schneeberger.com

SCHNEEBERGER SALES DEPARTMENTS

AUSTRIA AND SOUTH EAST EUROPE

Mobile +43 676 935 1035

E-Mail:
info-a@schneeberger.com

ISRAEL

Mobile +972 5 0551 7920

E-Mail:
info-il@schneeberger.com

BENELUX

Mobile +31 6 5326 3929

E-Mail:
info-nl@schneeberger.com

POLAND, SLOVAKIA, CZECH REPUBLIC

Mobile +420 6 0278 4077

E-Mail:
info-cz@schneeberger.com

DENMARK, SWEDEN

Mobile +31 6 5326 3929

E-Mail:
info-nl@schneeberger.com

RUSSIA, BELARUS, UKRAINE

Mobile +7 985 960 85 53
Mobile +38 050 407 6789
Mobile +37 529 860 0410

E-Mail:
info-ru@schneeberger.com

FRANCE

Mobile +33 6 0941 6269

E-Mail:
info-f@schneeberger.com

SPAIN, PORTUGAL ANDORRA

Mobile +34 69 559 05 99

E-Mail:
info-es@schneeberger.com

GREAT BRITAIN

Mobile +44 77 8814 5645

E-Mail:
info-uk@schneeberger.com

TURKEY

Mobile +90 545 320 83 55

E-Mail:
info-tr@schneeberger.com

www.schneeberger.com